

Planetary Gearhead GP 81 A $\varnothing 81$ mm, 15.4–92.3 Nm

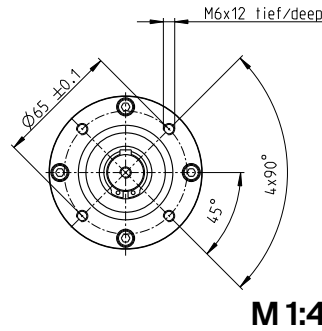
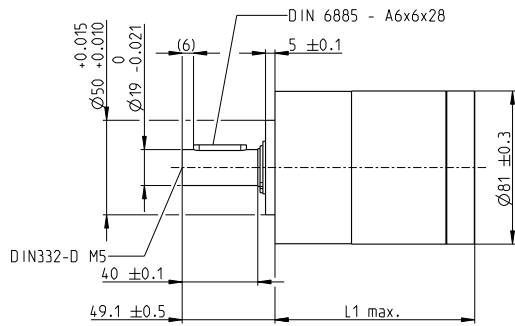

Technical Data	
Planetary Gearhead	straight teeth
Output shaft	steel
Bearing at output	ball bearing
Radial play, 8 mm from flange	max. 0.1 mm
Axial play	max. 1.28 mm
Max. force for press fits	1500 N
Direction of rotation, drive to output	=
Max. continuous input speed	3000 rpm
Recommended temperature range	-30...+120°C
Number of stages	1 2 3
Max. radial load, 29 mm from flange	400 N 600 N 1000 N
Max. axial load (dynamic)	80 N 120 N 200 N

gear

- Stock program
- Standard program
- Special program (on request)

Part Numbers

Gearhead Data	Part Numbers					
	701932	701933	701934	701935	701936	701937
1 Reduction	3.7:1	14:1	25:1	51:1	93:1	308:1
2 Absolute reduction	$\frac{63}{17}$	$\frac{3969}{289}$	$\frac{1701}{68}$	$\frac{250047}{4913}$	$\frac{107163}{1156}$	$\frac{19683}{64}$
3 Max. motor shaft diameter mm	14	14	14	14	14	14
4 Number of stages	1	2	2	3	3	3
5 Max. continuous torque Nm	15.4	46.2	46.2	92.3	92.3	92.3
6 Max. intermittent torque at gear output Nm	23.1	69.2	69.2	138.5	138.5	138.5
7 Max. efficiency %	80	75	75	70	70	70
8 Weight g	1902	2624	2624	3336	3336	3336
9 Average backlash no load °	0.5	0.55	0.55	0.6	0.6	0.6
10 Mass inertia gcm ²	192.86	183.6	90.29	182.92	90.9	88.48
11 Gearhead length L1 mm	91.9	113.6	113.6	135.2	135.2	135.2

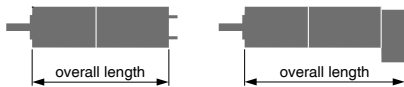

maxon Modular System										
+ Motor	Page	+ Sensor	Page	Brake	Page	Overall length [mm] = Motor length + gearhead length + (sensor/brake) + assembly parts				
RE 65, 250 W	153					223.40	245.10	245.10	266.70	266.70
RE 65, 250 W	153	HEDS 5540	487			249.30	271.00	271.00	292.60	292.60
RE 65, 250 W	153	HEDL 5540	489			249.30	271.00	271.00	292.60	292.60
RE 65, 250 W	153	HEDL 9140	494			279.50	301.20	301.20	322.80	322.80
RE 65, 250 W	153			AB 44	540	279.50	301.20	301.20	322.80	322.80
RE 65, 250 W	153	HEDL 9140	494	AB 44	540	297.50	319.20	319.20	340.80	340.80
EC 60, 400 W	242					269.30	291.00	291.00	312.60	312.60
EC 60, 400 W	242	HEDL 9140	493			269.30	291.00	291.00	312.60	312.60
EC 60, 400 W	242	Res 26	496			269.30	291.00	291.00	312.60	312.60
EC 60, 400 W	242			AB 41	539	282.90	304.60	304.60	326.20	326.20
EC 60, 400 W	242	HEDL 9140	493	AB 41	539	306.90	328.60	328.60	350.20	350.20