

# Planetary Gearhead GP 6 A $\varnothing 6$ mm, 0.002–0.03 Nm

gear

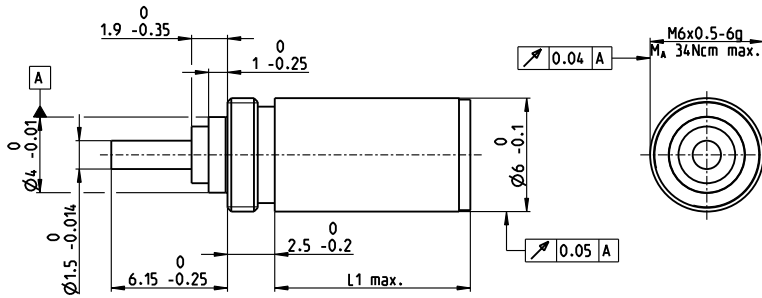

M 5:2

## Technical Data

Planetary Gearhead	straight teeth
Output shaft	stainless steel
Bearing at output	ball bearing
Option	sleeve bearing
Radial play, 5 mm from flange	max. 0.12 mm
Axial play	max. 0.10 mm
Max. axial load (dynamic)	5 N
Max. force for press fits	10 N
Direction of rotation, drive to output	=
Max. continuous input speed	40 000 rpm
Recommended temperature range	-40...+100°C
Number of stages	1 2 3 4 5
Max. radial load, 5 mm from flange	5 N 6 N 7 N 8 N 8 N

Gearhead Data	Part Numbers				
	472919	472920	472921	472229	472922
1 Reduction	3.9:1	15:1	57:1	221:1	854:1
2 Absolute reduction	$\frac{27}{7}$	$\frac{729}{49}$	$\frac{19683}{343}$	$\frac{531441}{2401}$	$\frac{14348907}{16807}$
3 Max. motor shaft diameter	mm 1	1	1	1	1
4 Number of stages	1	2	3	4	5
5 Max. continuous torque	Nm 0.002	0.005	0.010	0.030	0.030
6 Max. intermittent torque at gear output	Nm 0.005	0.010	0.020	0.060	0.060
7 Max. efficiency	% 88	77	68	60	52
8 Weight	g 1.7	2.1	2.5	2.9	3.3
9 Average backlash no load	° 1.8	2.0	2.2	2.5	2.8
10 Mass inertia	$\text{gcm}^2$ 0.001	0.001	0.001	0.001	0.001
11 Gearhead length L1	mm 5.3	7.8	10.4	13.0	15.6

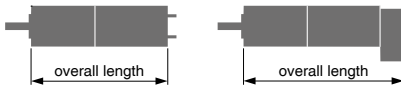

maxon Modular System				
+ Motor	Page	+ Sensor/Brake	Page	Overall length [mm] = Motor length + gearhead length + (sensor/brake) + assembly parts
RE 6, 0.3 W, A	117			21.0 23.5 26.1 28.7 31.3
RE 6, 0.3 W, B	117			25.0 27.5 30.1 32.7 35.3